

# L39

EN 442 & EN14037 tested

- > Gym Wall Radiant Panel
- > Water Based
- > Wall Mounted

## APPLICATION

The L39 is an extruded aluminium radiant heating strip that provides exceptionally high heat transfer. It offers a modular indoor solution that has been designed specifically for gymsnasia. Operating with a proven water-based heat exchange system that operates from a boiler.

## DESIGN

### Construction:

Extruded aluminium planks, copper tubing with 15 mm connection and rFoil™ insulation.

### Finish:

RAL 9010 White polyester powder coating.

### Options:

- anti-bacterial coating
- connection types
- access panel

## FEATURES

Impact resistant sloping sides

Mean water temp: 45°C to 80°C

Coil passes: 4, 6, 8, 10, 12, 14

Max. length: up to 4,800 mm  
(in one piece)

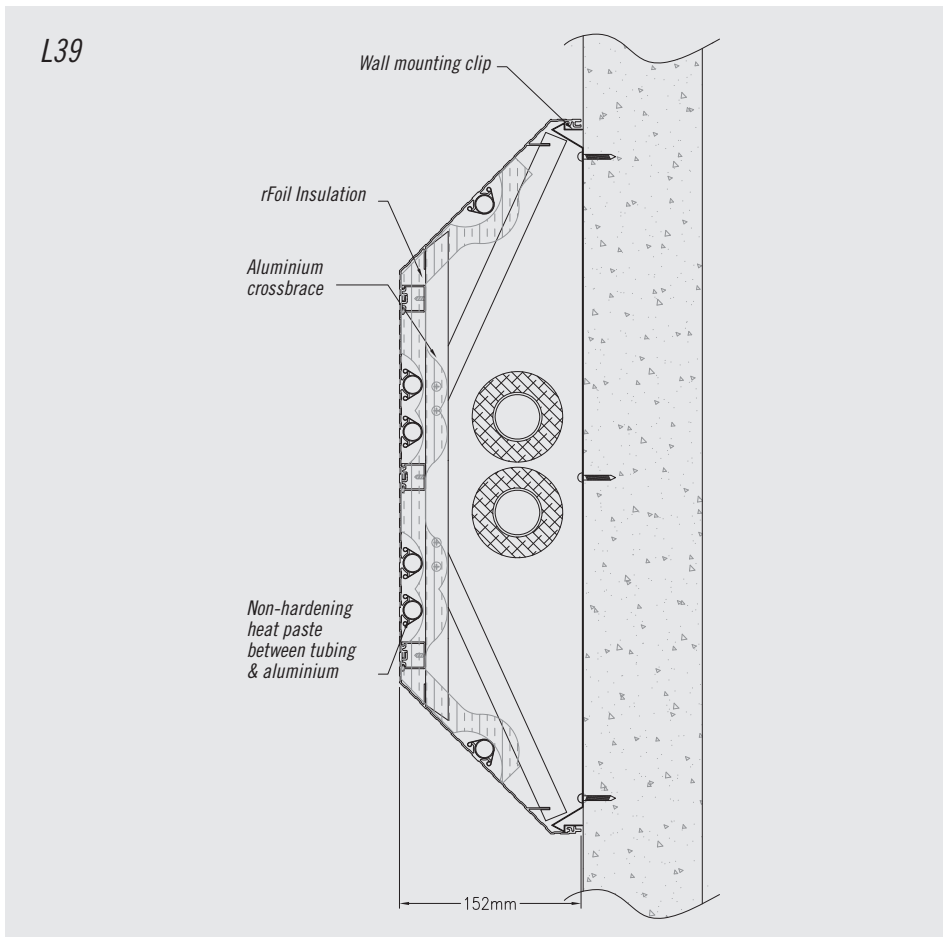

## REMARKS

All dimensions are given in mm.

# L39 – PERFORMANCE DATA

L39 PERFORMANCE	Width (mm)	Mean Water Temperature °C							
		45	50	55	60	65	70	75	80
4 PASSES	450	101	124	135	200	218	250	297	318
4 PASSES	600	150	187	201	258	294	336	367	406
6 PASSES	600	156	195	209	269	308	350	386	427
6 PASSES	750	179	224	238	309	355	400	446	501
8 PASSES	750	188	235	249	324	373	420	468	530
8 PASSES	900	221	277	292	381	439	494	549	636
10 PASSES	900	228	285	301	392	452	508	565	653
10 PASSES	1050	258	322	341	443	513	575	639	743
12 PASSES	1050	266	332	351	456	528	592	658	763
12 PASSES	1200	296	368	389	506	586	658	732	849
14 PASSES	1200	305	379	400	521	603	677	754	872
12 PASSES	1350	334	413	437	568	658	739	823	955
14 PASSES	1350	344	425	450	585	677	761	848	982

## NOTES

Outputs are based on 21°C room temperature. For every 1°C decrease in temperature below 21°C, the output increases by 2%.