

L24



- > Linear panel
- > Radiant heating
- > T-Bar mounting
- > Low profile

APPLICATION

The L24 is an extruded aluminium radiant heating strip that provides exceptionally high heat transfer. It offers a modular indoor solution that has been designed specifically for T-Bar ceiling integration. Operating with a proven water-based heat exchange system that will operate from a boiler.

FEATURES

Mean water temp: 45°C to 80°C
 Max. length: up to 3000 mm
 Coil passes: 4, 6 or 8

DESIGN

Casing
 material: extruded aluminium planks
 finish: white polyester powder coating
 colour: RAL 9010

Pipework
 16 mm tubes: copper

Clips
 joint/suspension: cadmium or zinc-plated steel

Insulation
 material: rFOIL™

AVAILABLE TYPES

L24

L linear panel
24 595 mm width

- **heating**
water based heat exchange
- **cooling**
radiant cooling

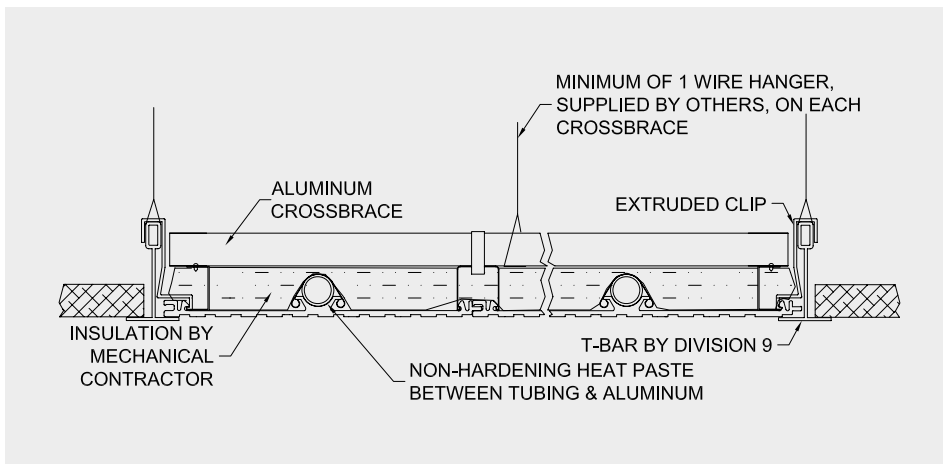

REMARKS

All dimensions are given in mm.
 Copper pipework has 15 mm brazed ends.

L24 PERFORMANCE	Width (mm)	Mean Water Temperature °C							
		45	50	55	60	65	70	75	80
4 PASSES	600	150	187	201	258	294	336	367	406
6 PASSES	600	156	195	209	269	308	350	386	427
8 PASSES	600	163	204	217	281	323	364	406	448

Outputs expressed in watts per linear metre and are based on 21°C room temperature.
 For every 1°C decrease in temperature below 21°C, the output increases by 2%.